



QIP is a four channel, transimpedance, AC or DC coupled preamplifier. It is designed to work with either biased or non-biased, uncooled, quadrant geometry detectors in TO8 package. QIP provides a broad bandwidth up to 100MHz.

Code description

QIP - 10k - 100M

VIGO preamplifier type

Low cut-off frequency f_{lo} [Hz]:

DC
10
100
1k
10k

High cut-off frequency f_{hi} [Hz]:

100k
300k
1M
5M
10M
100M

Dimensions [mm]

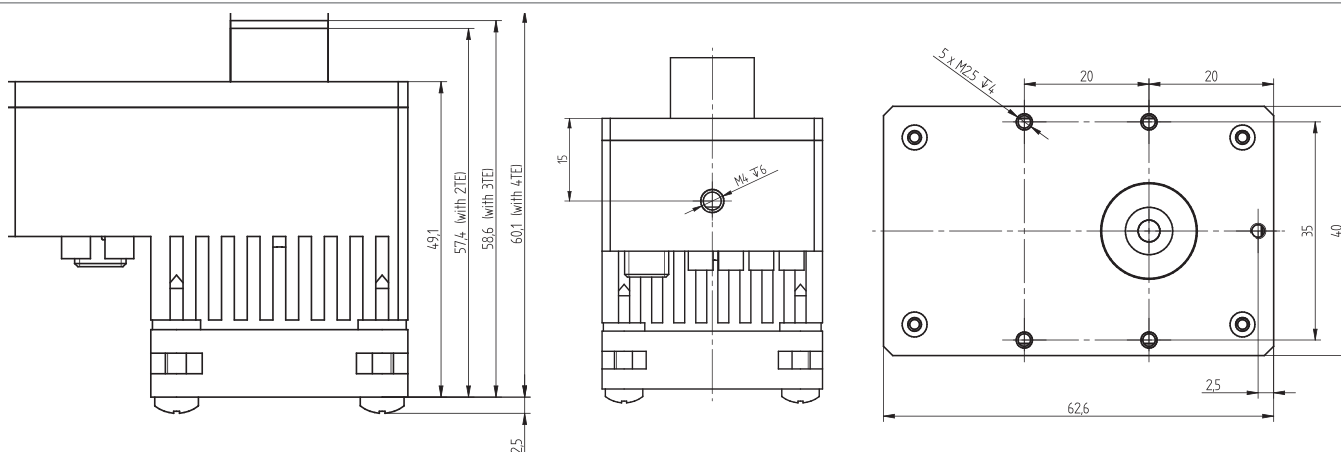

Power supply connector - DC Jack connector

Type	Voltage [V]	Pin diameter
DC Jack – 2.5	9 -12	Ø 2.5
DC Jack – 2.1	5	Ø 2.1

